

# Connector One

## Extension module



### Benefits:

- One interface for monitoring and controlling most of dormakaba automatic doors.
- Reduced wiring effort. LAN-communication instead of dry-contacts.
- Easy and fast integration into smart building systems.
- Compatible with the RC Touch control unit.
- Different secure communication levels selectable.
- Configuring and maintaining with a web browser.

### Connector One

The Connector One is an extension module for door operators, automatic doors or door systems. It extends the door controller with a LAN interface for an easy integration into latest smart building systems. The communication between a central system and the Connector One is done by the OPC UA standard. It enables a powerful and secure connection, for monitoring and controlling the automatic doors.

Every smart building system, that can act as an OPC UA client, is able to communicate with a Connector One. Integration of automatic doors in a smart building was never before as easy as now.

### Features

Depending on the connected door operator or door type, the Connector One offers up to hundreds of datapoints about the door state and system conditions. It also offers different control functions, that can be use for direct use or in an automized environment.

The Connector One automatically detects which type of door is connected and adapts the OPC UA model accordingly. For controlling the automatic door, OPC UA methods or alternatively writable variables can be used.

A small RGB-LED indicates the device state, that helps the technician while commissioning or in case of service and maintenance.

### High Range of Compatibility

One device for all. The Connector One supports most of our current door types. More will follow.

# Connector One

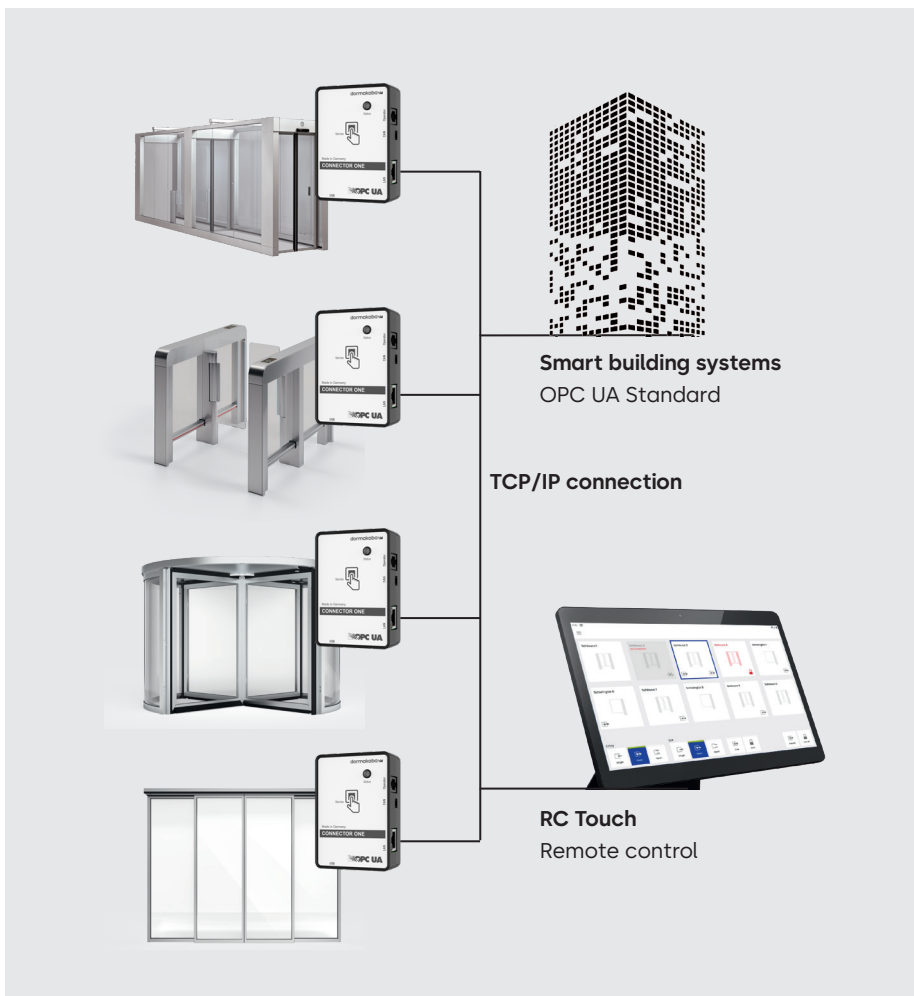

## Supported products

- **Swing door operators**  
ED100, ED250, ED900
- **Sliding door operators**  
ES200, ES PROLINE
- **Revolving doors**  
KTV, KTC 2, Geryon SRD
- **Folding doors**  
FFT
- **Tripod barriers**  
Kerberos TPB
- **Turnstiles**  
Charon HTS, Kentaur FTS
- **Swing doors**  
Charon HSD, Kentaur FGE-Mxx
- **Sensor barriers**  
Argus HSB, Argus 40/60/80, Argus V60
- **Security Gates**  
Orthos PIL-M02

## Security

- Hardened embedded OS, which detects system manipulations.
- Firewall protected.
- Authorization by username/password or server/client certificates.
- Encrypted communication.
- Critical changes of system parameters remotely not possible. Physical access to the device and a password are necessary.

## Commissioning

Installation and configuration with small effort. Just one cable for data and power. Configuration is done over the LAN interface and using a web browser. Every parameters are available in the onboard service-menu, which is enableable with the service-button.

## Technical Data

Dimensions:	88 × 60 × 30 mm
Power Supply:	24 V DC
Power Consumption:	1 W
Operating Temperature:	-15 to +55 °C
Weight:	75 g
Communication Protocol:	OPC UA

**Any questions? We would be happy to answer any questions you may have.**

dormakaba International Holding AG | Hofwisenstrasse 24 | CH-8153 Rümlang | info@dormakaba.com | dormakaba.com