



dormakaba access manager 92 32 for exivo

Optimised for single access points

dormakaba access manager 92 32 is a high-performance access control system optimised for single access points. Thanks to its intelligent decision logic and ability to be freely parametrised, the access manager can control simple types of access as well as more complex entrance and exit door configurations.

Simple installation, efficient operation

dormakaba access manager 92 32 fulfils all the requirements of a modern security concept and yet at the same time is easy and efficient to install and operate. Fast and simple assembly on doors reduces the amount of installation work and costs required.

Minimal cabling work, lower costs

dormakaba access manager 92 32 can use the building's modern IT infrastructure, minimising the amount of cabling required. Power over Ethernet (PoE) can supply all of the power, avoiding the need for additional power supplies.

Compact and discreet design

If the 92 32 access manager needs to be installed in full view, its compact and discreet dormakaba design ensures it blends seamlessly into any building structure.

Advantages at a glance

Minimal cabling required

Modern IT infrastructure used

Efficient installation

Fast and simple to carry out, no electricians required.

Simple planning

One device for single access points and one for double access points

Seamless integration

Easy integration into existing systems.

Independent

Autonomy ensured through own decision logic and local data storage

Future-proof

Designed for use with dormakaba mobile access

Discreet design

Blends in seamlessly when installed in full view.

Features



Technical specification

Supported RFID technologies

- LEGIC advant

Dimensions

- 208 x 208 x 48 mm (W x H x D)

Housing

- Wall mounting
- Colour: Light grey NCS 1502-B, front cover in white RAL: 9016

Interfaces

- Ethernet 10/100 Mbps with DNS/DHCP server
- 2 coaxial connections for registration units
- 4 digital inputs: max. 5 V DC
- 3 relay outputs: 30 V AC/DC; max. 2 A

Power supply

- PoE (IEEE 802.3af), 15.4 W
- PoE+ (IEEE 802.3at), 25.5 W
- 24 V DC

Ambient conditions:

- Protection type: IP40
- Relative humidity: 5% to 85%, non-condensing
- Temperature range: -0 °C – +50 °C (in operation)

Further details and order information can be found in the relevant dormakaba catalogues or system descriptions.

Subject to change without notice.
©2018 dormakaba. Version 09/2018

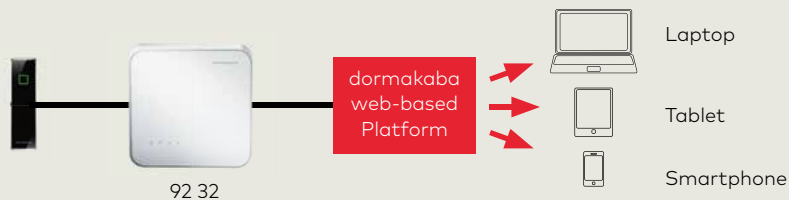

dormakaba access manager 92 32 is connected to its access components, and via Ethernet cable to the dormakaba web platform and the relevant access system.

Door management

The access manager 92 32 manages and controls single access points, regardless of whether they are single doors or more complex access points.

Online/offline operating states

The access manager can make centralised or local decisions depending on whether it is operating in online or offline mode.

Reliable operation

The system automatically restarts after a power failure, ensuring that the system is fully available again immediately.

Supported peripherals

Two registration units can be connected:

- dormakaba registration units 90 00 / 90 01 / 90 02 / 90 04

Connections

All of the connections are designed as plug-in screw terminals, which ensures that installation is quick and easy. The different colours and labelling directly on the terminal ensure you get an overview very quickly.

Tamper proofing

The integrated tamper switch ensures any attempts to tamper with the device send an alarm to the access system.

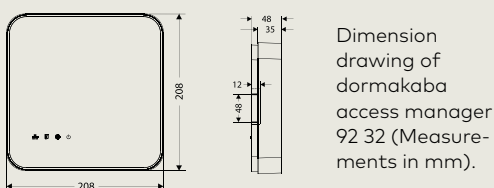

Any questions? We would be happy to answer any questions you may have.